

A75 CLOSE END IDC SOCKET

PITCH: 2.0mm * 2.0mm

SPECIFICATIONS

Material

Insulator : PBT, glass reinforced, rated UL 94V-0
Contact : Phosphor Bronze

Electrical

Current Rating : 1 Amp
Contact Resistance : 30 mΩ max.
Insulation Resistance : 3000 MΩ min.
Dielectric Withstanding Voltage : 500V AC for 1minute
Operating Temperature : -40°C to +105°C
▶ Terminated with L02-1.00mm pitch flat ribbon cable.
▶ Mating Suggestion: C106, C106a, & C106b series.

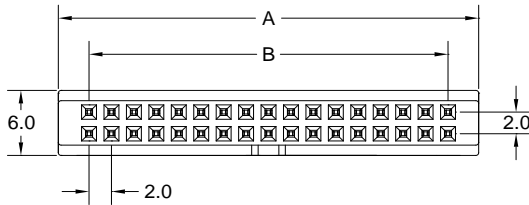
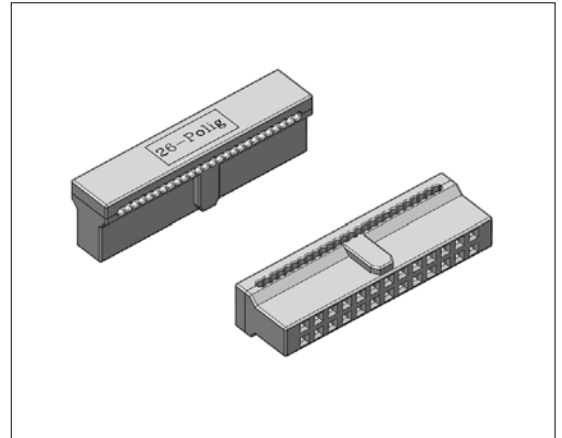

POSITION	A	B
4	7.47	2.00
6	9.47	4.00
8	11.47	6.00
10	13.47	8.00
12	15.47	10.00
14	17.47	12.00
16	19.47	14.00
20	23.47	18.00
24	27.47	22.00
26	29.47	24.00
30	33.47	28.00
34	37.47	32.00
40	43.47	38.00
44	47.47	42.00
50	53.47	48.00

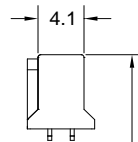
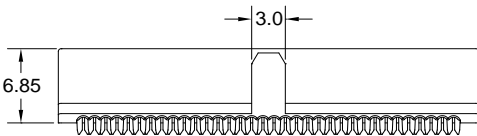

(8.65)
TERMINATED
HEIGHT

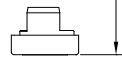
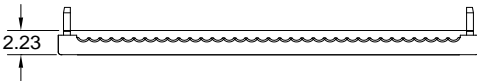

How to order: A75 - 1 - 2 - 3 - 4 - 5 - G(RoHS)

1.NO. OF CONTACT	2.CONTACT MATERIAL	3.CONTACT PLATING	4.SPECIAL FUNCTION	5.INSULATOR COLOR
04 06 08 10 12 14 16 20 24 26 30 34 40 44 50	B: PHOSPHOR BRONZE	T: TIN PLATED S: SELECTIVE G: GOLD FLASH A: 5u" INCH GOLD B: 10u" INCH GOLD C: 15u" INCH GOLD D: 30u" INCH GOLD	B: W/O STRAIN RELIEF W BAR	1. BLACK



DON CONNEX
ELECTRONICS CO., LTD

T:886 2 86483356 | F:886 2 86485885
e-mail: info@donconnex.com.tw



Connector: E163339 | Flat cable: E162690
Wiring Harnesses: E312257

